

This drawing to be read in conjunction with all specifications and all other consultants design information. Any contradictions between this drawing and any other design information to be advised to the contract administrator and author immediately.

The contractor to site measure, check and verify all information issued, and confirm the correctness of the contents prior to the commencement on site.

The contractor to comply with all current statutory legislation, Building Regulations, British Standards, and good building practice.

Do not scale from this drawing.

Revision	Date	Init
rev	description	date
		dr by / ap by

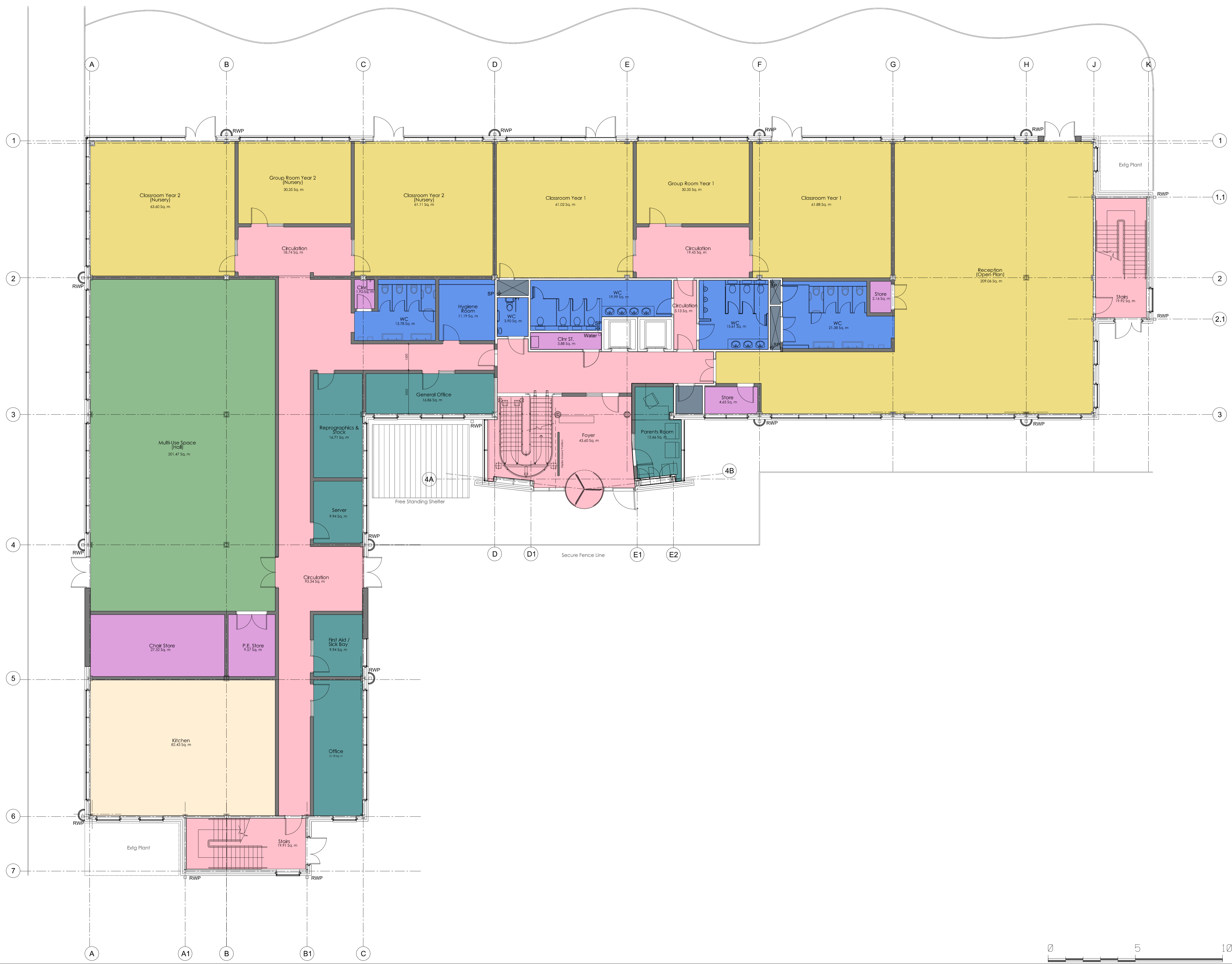

**KEY**

- Teaching Space
- Hall & Dining
- Staff & Admin
- Learning & Support
- WC & Hygiene
- Stores
- Circulation
- Plant
- New Wall

**NOTES:**

- Any areas shown supersede schedule of accommodation issued as part of the original bid.
- Layouts shown are subject to:
  - Land ownership confirmation
  - Cost Plan
  - Topographical, building and condition surveys
  - Structural input
  - Mechanical and Electrical review
  - Intrusive survey
  - Services
  - Easements
  - Statute regulations
  - Planning approval and relevant policies
  - Building regulations
  - Rights of Light
- Levels shown are indicative and subject to existing building constraints.
- Structure, FF&E and M&E services are subject to information provided by others.
- Any structure shown is for indicative purposes only, please see structural engineers information for structural design requirements.
- Extent of soft and hard landscaping to be confirmed.

client: Knowledge School Trust / EFA			
project: Knowledge School, Rugby			
title: Proposed Ground Floor Plan			
date: 14.04.2015	scale: 1:100@A1	status: Preliminary	
drawn by: AA	job NO: 15008	dwg NO: A106	rev: -
checked by: MB			

© the drawing, design and the building works depicted are the copyright of Glancy Nicholls Architects Ltd & may not be reproduced or amended, except by the written permission of Glancy Nicholls Architects Ltd. No liability will be accepted for any amendments made by other persons. The issue of this drawing/document does not confer any licence for use of the design to any party whatsoever save as expressly agreed by Glancy Nicholls Architects Ltd.

**Glancy Nicholls Architects**

Glancy Nicholls Architects Ltd  
The Engine Room  
2 Newhall Square, Rhym, 83 1RU  
registration No: 3141809

tel: 0121 456 7424  
fax: 0121 456 7425  
e-mail: architects@glancynicholls.com